

FACT SHEET: **Transit**

Mountain View Light Rail Double Tracking Project

Project Overview

The Mountain View Double Tracking Project has three components and when all are complete, a second light rail track will be put into operation between the Mountain View Transit Center and the Whisman Station.

Currently there is only one set of tracks between the two stations, a situation that often creates a bottleneck adversely impacting light rail schedules (and disrupts rider's connections to Caltrain) and also limits the amount of service VTA can offer at the Mountain View Transit Center.

Project Benefits

Adding the second set of tracks will immediately increase the reliability of connections between VTA light rail riders and Caltrain and will also improve the reliability of the light rail schedule throughout the system.

In addition, the project also addresses the need to add capacity on 49ers game days at Levi's Stadium, which opens in August 2014 and hosts the Super Bowl in February 2016.

Phase One

Phase One will add 1,400 feet of light rail track by extending the existing storage track to just west of SR 85. In addition, a new storage track will be constructed. The Phase One construction contract is expected to be awarded in August, 2014 and work to be completed by July 2015. Stevens Creek, which flows underneath this track, is not impacted by the construction.

Caltrain Realignment

In order to accommodate the second set of light rail tracks, Caltrain tracks will need to be re-aligned between the existing Evelyn Station and SR 237. This work will be completed by December 2014.

Phase Two

Phase Two extends the second set of light rail tracks by about 3,000 feet from SR 85 to Whisman Station.

This work will require the permanent closure and removal of the Evelyn Light Rail Station, which is situated between the Caltrain tracks and current single VTA track. If approved, the closure would take place in January 2015. Average weekday ridership at the Evelyn Station is 66 boarding a day, which is the second lowest in the VTA light rail system. The proposed station closure would not impact the Evelyn Park & Ride lot which would remain in service. The Phase Two construction contract is expected to be awarded in December 2014, with work slated to be completed in November 2015.

Project Cost

Projected costs for Phase One, the Caltrain Re-Alignment and Phase Two is \$63 million.

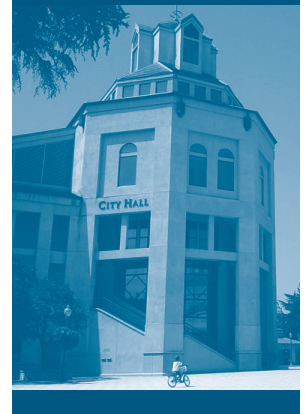

Continued on back

Mountain View Light Rail Double Tracking Project

Proposed Light Rail Improvements in Mountain View

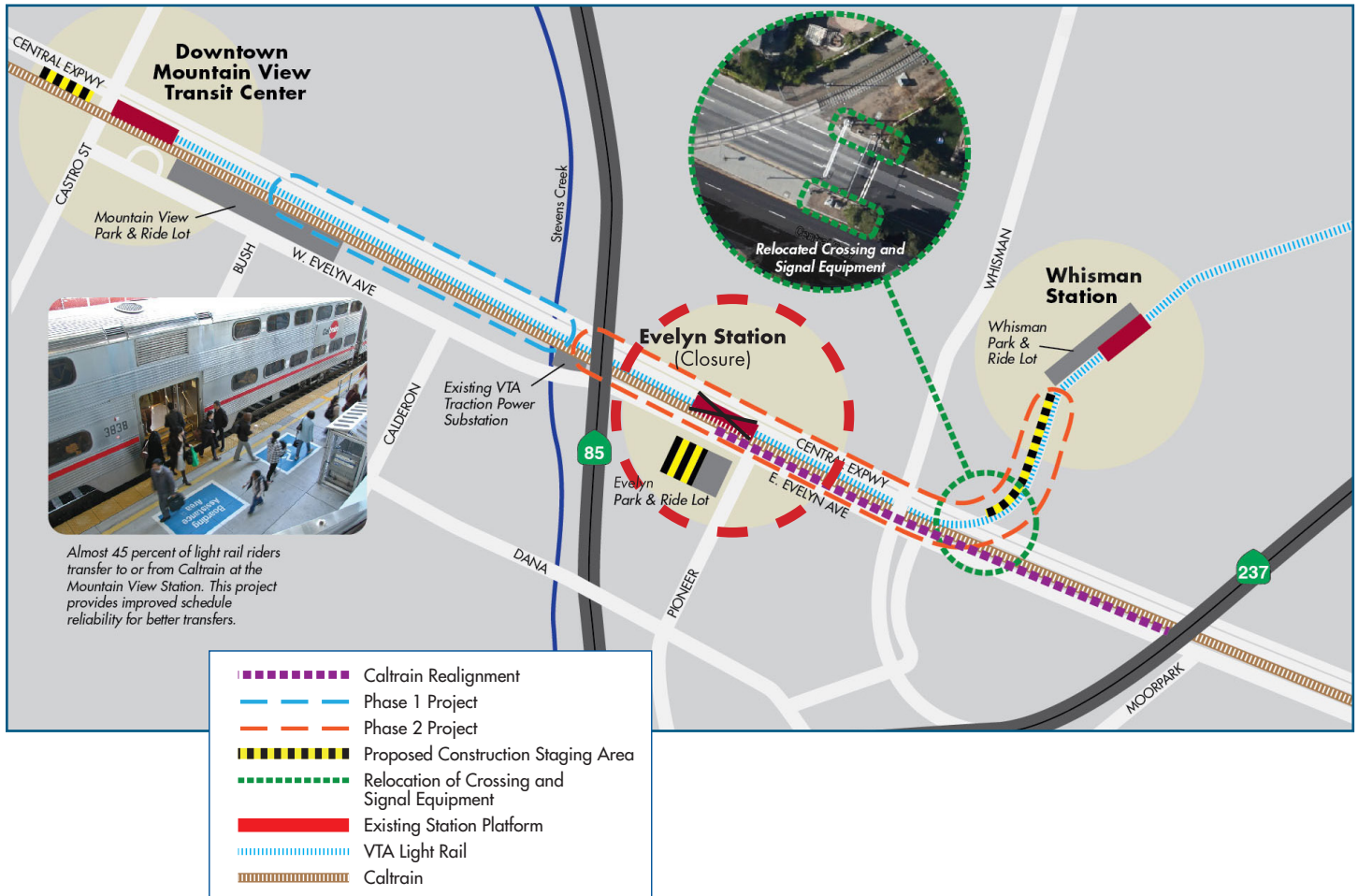

How to Reach Us

For more information on the Mountain View Light Rail Double Tracking Project call VTA Community Outreach at (408) 321-7575, TTY only (408) 321-2330, email community.outreach@vta.org or visit us on the web at <http://www.vta.org/lightrail>.

VTA Mission: VTA provides sustainable, accessible, community-focused transportation options that are innovative, environmentally responsible, and promote the vitality of our region.