

FACT SHEET:

28TH ST / LITTLE PORTUGAL STATION

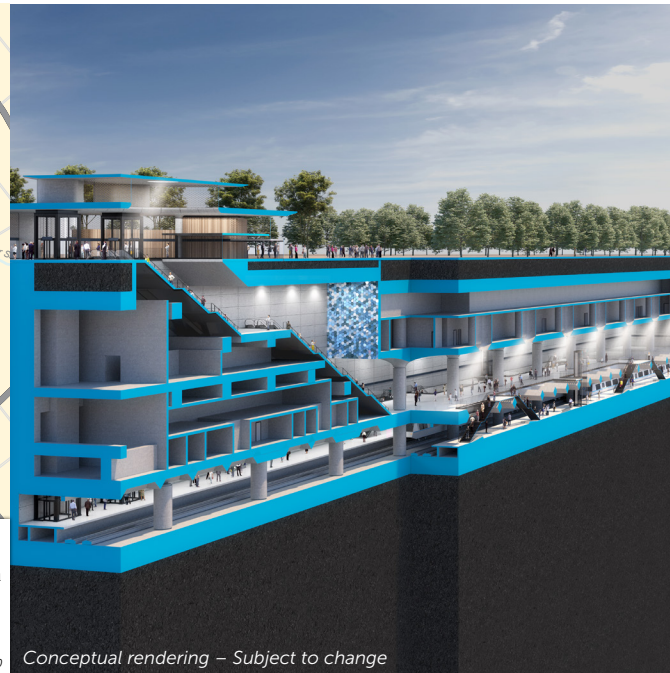

The 28th Street/Little Portugal Station will be between US-101 and 28th Street, just north of East Santa Clara Street. This station will consist of a ground-level station with underground side platforms with tracks in the center. Ticketing and fare gates will be at street-level. Passengers will be able to access the station from the corner of 28th Street and Five Wounds Lane. Vehicle parking and bicycle facilities will be available at this station.

Little Portugal, as the neighborhood is known, is full of history and beautiful architecture. It is one of the largest Portuguese communities in the country and is home to numerous Portuguese businesses and the Five Wounds Portuguese National Parish, which has been declared a historical landmark by the City of San José.

28th Street / Little Portugal Station: At a Glance



6,700

Weekday riders
in 2040



8 Neighborhoods
within walking
distance



6 Schools
surround the station



Located in one of
the nation's
largest Portuguese
communities



Connection to Future
Five Wounds Trail

VTA's BART Silicon Valley Phase II Extension (Phase II Project) is a six-mile, four-station extension of BART from Berryessa/North San José Station (opened 2020) through downtown San José to the City of Santa Clara. The Phase II Project is planned to include an approximately five-mile subway, three stations with underground platforms (28th Street/Little Portugal, Downtown San José, and Diridon), one ground-level station (Santa Clara), a train maintenance and storage facility, and additional facilities.







Continued on back.

Project Funding Partners

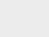

VTA's BART Silicon Valley Phase II Project

LEGEND

-  Station Entrance Building
-  Station Platform (Underground)
-  At-Grade Vent/Egress Facilities
-  Station Access Facilities, Parking, and Future Potential Transit-Oriented Development
-  Construction & Staging Areas (under consideration)
-  Station Entrance & Exit
-  Tunnel

NOTE:

- Temporary and intermittent lane and street closures expected in Construction & Staging Areas.
- This is a planning document subject to change.

