

FACT SHEET: DOWNTOWN SAN JOSÉ STATION

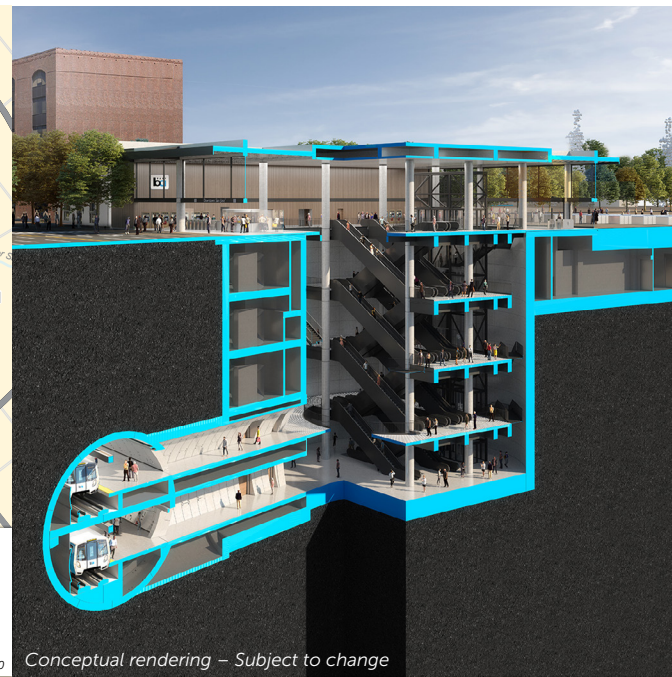

Downtown San José Station will be on Santa Clara Street with the main station entrance between Market and 1st Streets and the secondary entrance between 1st and 2nd Streets. An emergency egress and ventilation facility will be at the northwest corner of 3rd Street. Ticketing and fare gates will be at street-level at both entrances while the station's concourse and stacked platforms will be underground. There will be bicycle parking and convenient connections to VTA light rail and bus service on Santa Clara, 1st, and 2nd Streets. The station area will be integrated with planned on-site development, helping transition Downtown into a transit oriented community.

In recent years, San José's Downtown has seen a resurgence with additional innovative tech companies, local retail and restaurants, and multiple residential towers. All this and more will be accessible and within walking distance from the future Downtown San José Station.

Downtown San José Station: At a Glance



27,900
Weekday riders
in 2040



250+ Multicultural
restaurants within
walking distance



Within walking
distance to **San José
State University**



Center of
Silicon Valley's
Business District



Surrounded by
numerous art and
event venues

VTA's BART Silicon Valley Phase II Extension (Phase II Project) is a six-mile, four-station extension of BART from Berryessa/North San José Station (opened 2020) through downtown San José to the City of Santa Clara. The Phase II Project is planned to include an approximately five-mile subway, three stations with underground platforms (28th Street/Little Portugal, Downtown San José, and Diridon), one ground-level station (Santa Clara), a train maintenance and storage facility, and additional facilities.

Continued on back.

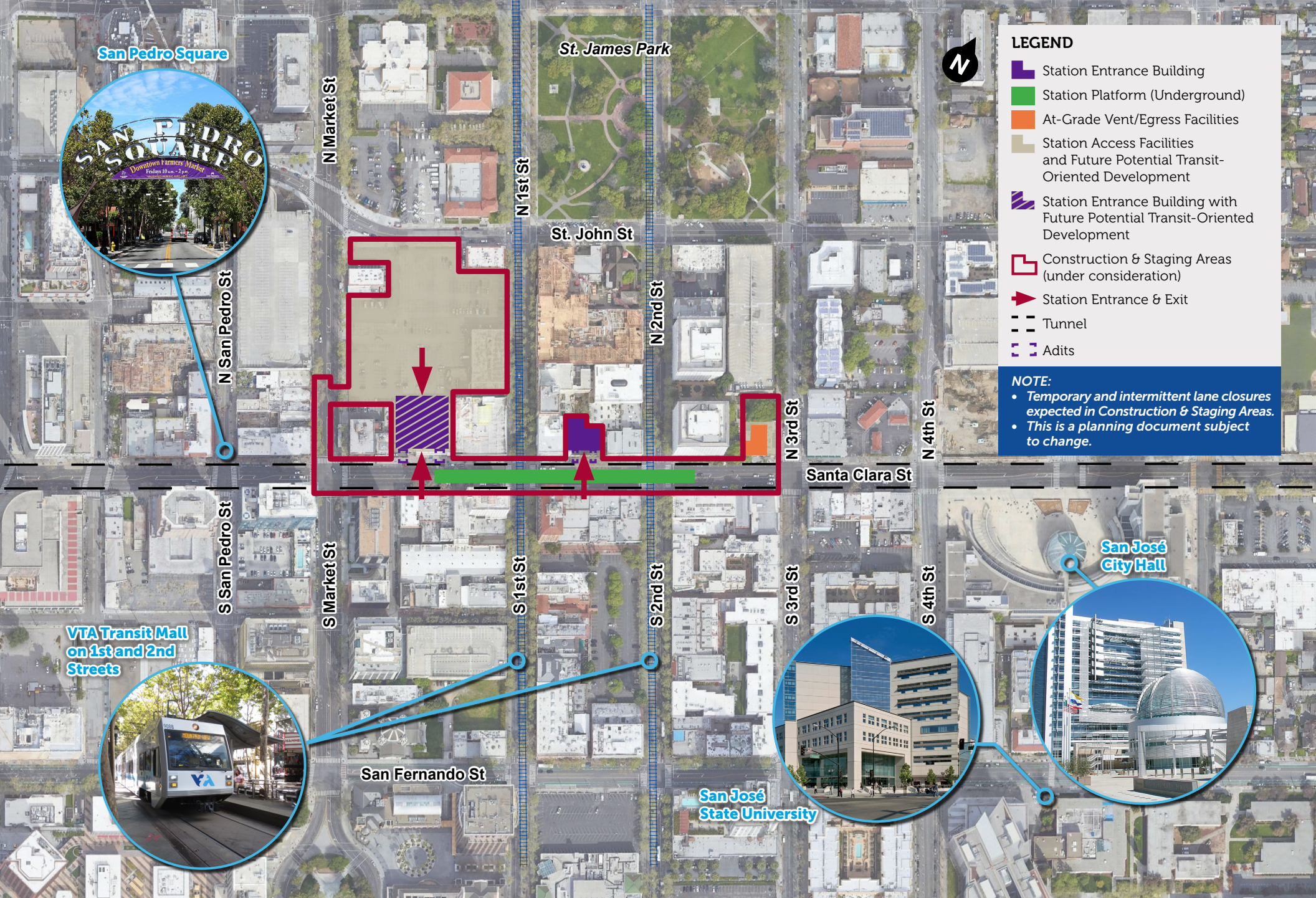

LEGEND

- Station Entrance Building
- Station Platform (Underground)
- At-Grade Vent/Egress Facilities
- Station Access Facilities and Future Potential Transit-Oriented Development
- Station Entrance Building with Future Potential Transit-Oriented Development
- Construction & Staging Areas (under consideration)
- Station Entrance & Exit
- Tunnel
- Adits

NOTE:

- Temporary and intermittent lane closures expected in Construction & Staging Areas.
- This is a planning document subject to change.

